

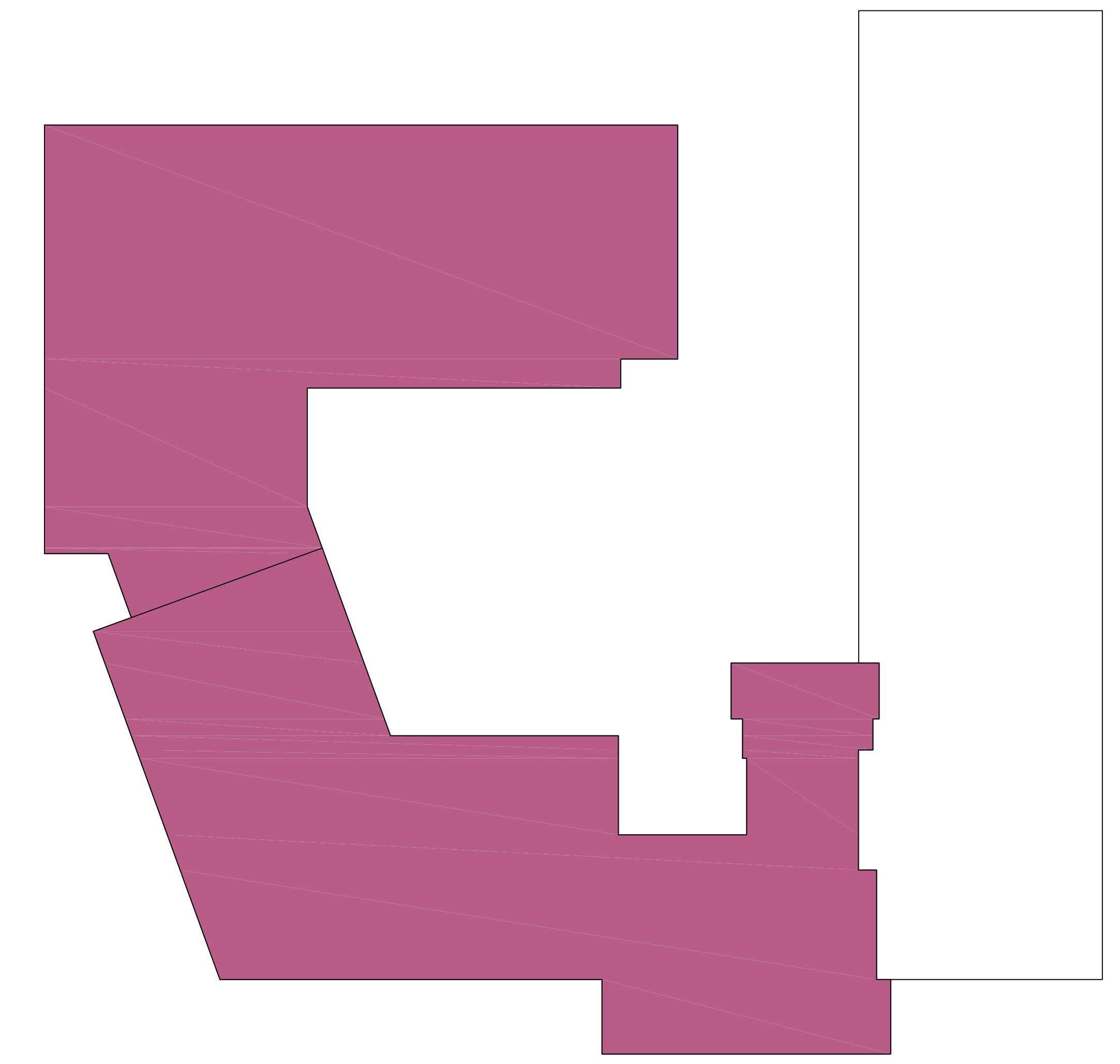

TYPICAL FLOOR 2-3



FOURTH FLOOR



ROOF PLAN

POPE HALL

CONSTRUCTION ZONES - SUMMER 2008

May 21 - August 8

SCOPE OF WORK:

- CONTINUE WITH ADDITION FOUNDATIONS, STRUCTURE AND INFRASTRUCTURE
- FRAME BUILD-OVER OF PORTION OF EXISTING
- ROOFTOP EQUIPMENT AND DUCTWORK FOR EAST FRESH AIR LOOP (EXHAUST SIDE TO BE FULLY OPERATIONAL AT END OF PHASE)
- BUILD NEW HEATING AND DOMESTIC WATER PLANTS
- BUILD NEW MAIN ELECTRIC SERVICE; BACKFEED MAIN ELECTRIC PANELS
- COMPLETE BATHROOM SCOPE IN EXISTING BUILDING WITH THE EXCEPTION OF THE RD APARTMENT
- COMPLETE SANITARY SCOPE IN EXISTING BUILDING, INCLUDING STREET TAP
- COMPLETE BASEBOARD HW HEATING SCOPE IN EXISTING BUILDING
- TEMP EXHAUST AND PLUMBING VENTS FOR CENTER BATH CORE
- ALL HVAC WORK FOR THE EAST SIDE FRESH AIR LOOP SUPPLY SIDE WITHIN BATH CORES



GROUND FLOOR



FIRST FLOOR

SCOPE (cont'd):

- TEMP REMOVAL AND REINSTALLATION OF EXISTING SUSPENDED CEILINGS TO FACILITATE OTHER TRADES' WORK
- LIMITED ABATEMENT SCOPE PER PLANS
- EXISTING FIRE ALARM, FIRE PROTECTION, SECURITY AND VOICE DATA VIDEO SYSTEMS ARE EXISTING TO REMAIN / PROTECT FROM DAMAGE
- DEMOLISH TWO-STORY LOUNGE STRUCTURE, PROCEED W/ ELEVATOR PIT AND FOUNDATIONS
- DEMOLISH ROOF SLAB PROJECTION
- NEW ROOF ON EXISTING BUILDING EAST WING / ADDITION, TEMP-IN FUTURE OPENINGS FOR MEP / FP PENETRATIONS



CONSIGLI
Est. 1905